

DuraSquare Furniture washbasin Compact # 2356600040 / 2356600041 / 2356600044 / 2356600070

< 23 5/8" Inch >

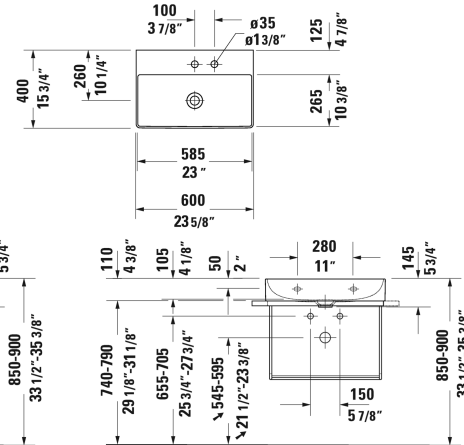
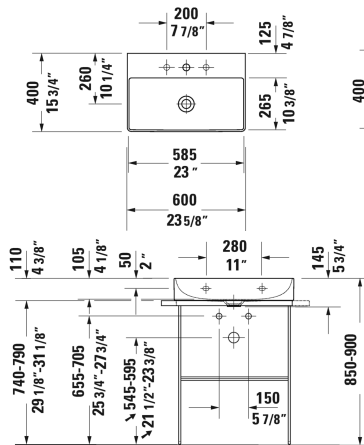
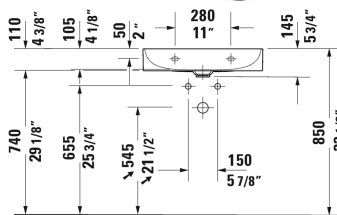

Furniture washbasin Compact	Dimension	Weight	Order number
without overflow, with faucet deck, ceramic covered slotted waste included, underside fully glazed, 23 5/8" Inch			
Colors			
00 White			
Variant			
● ●	23 5/8" x 15 3/4" Inch	28.4 lb	2356600040
●	23 5/8" x 15 3/4" Inch	28.4 lb	2356600041
● ● ●	23 5/8" x 15 3/4" Inch	28.4 lb	2356600044
☒	23 5/8" x 15 3/4" Inch	28.4 lb	2356600070
Infobox			
Made of DuraCeram, For glass inserts matching to furniture lacquer finishes, please see page XXX, Metal console: Towel rail can be mounted right or left			
Sanitary ceramics with the special WonderGliss surface finish will remain clean and attractive-looking for a long time to come. When ordering WonderGliss please add a "1" as eleventh digit to the model number.			
Towel rail square tube 1/2", Chrome, for washbasin # 045460, 235060, 235360, 235660	21 5/8" Inch	0.8 lb	003037
Design Siphon		3.3 lb	005036
Suitable products			

DuraSquare Furniture washbasin Compact # 2356600040 /
2356600041 / 2356600044 / 2356600070

|< 23 5/8" Inch >|

Vanity unit wall-mounted Compact 1 pull-out compartment, 23" x 15 3/8" Inch	23" x 15 3/8" Inch	XS4067
Vanity unit wall-mounted Compact 2 drawers, upper drawer including cut-out for siphon and siphon cover, 23" x 15 3/8" Inch	23" x 15 3/8" Inch	XS4167
Vanity unit floorstanding Compact 2 pull-out compartments, integrated legs with height adjustment, 23" x 15 3/8" Inch	23" x 15 3/8" Inch	XS4453
Metal console floorstanding ** height adjustable +2", hardware included, for washbasin # 235660, towel rail right or left, reversible, 26 1/8" x 15" Inch	26 1/8" x 15" Inch	003113
Metal console wall-mounted ** hardware included, for washbasin # 235660, towel rail right or left, reversible, 26 1/8" x 17 3/4" Inch	26 1/8" x 17 3/4" Inch	003114
Glass inserts safety glass, for metal console # 003113, 003114, 22 1/2" x 12 1/4" Inch	22 1/2" x 12 1/4" Inch	009968

All drawings contain the necessary measurements which are subject to standard tolerances. They are stated in inch & mm and are non-binding. Exact measurements, in particular for customized installation scenarios, can only be taken from the finished ceramic piece.